

M6

QA116-T-01

Montage:
Montaggio:
Montering:
Felszerelés:
Montaż:

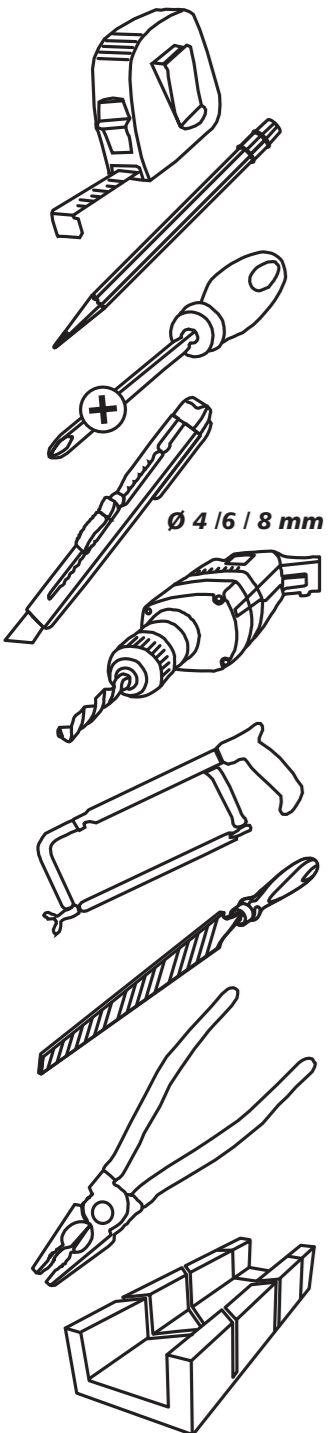
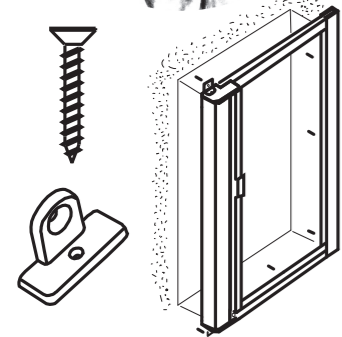

Ø 4 / 6 / 8 mm

M6 Montage 6 / (D) Frontal-Montage, geschraubt / (I) Montaggio frontale, avvitato / (F) Montage frontal vissé QA116-F-01

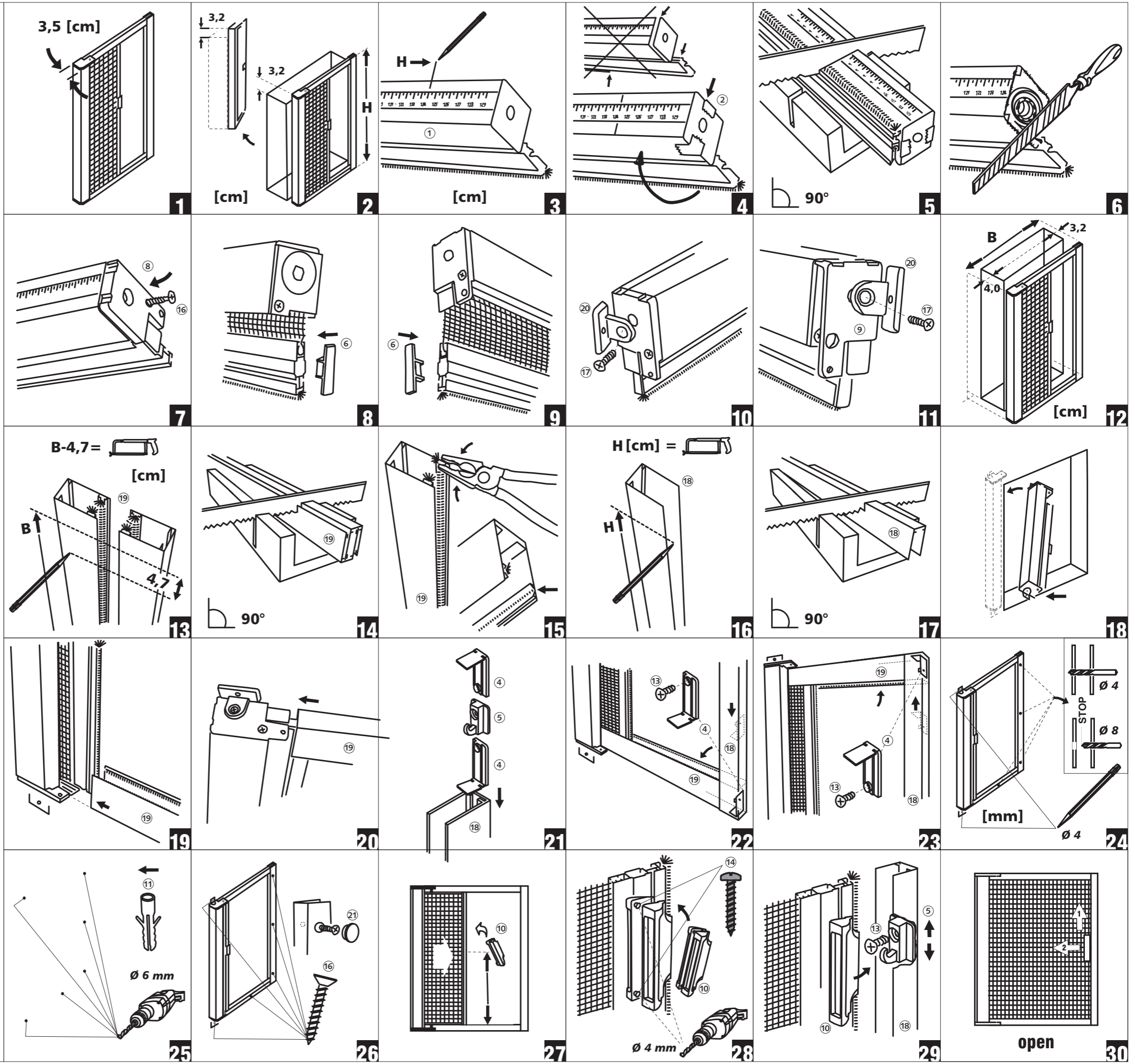
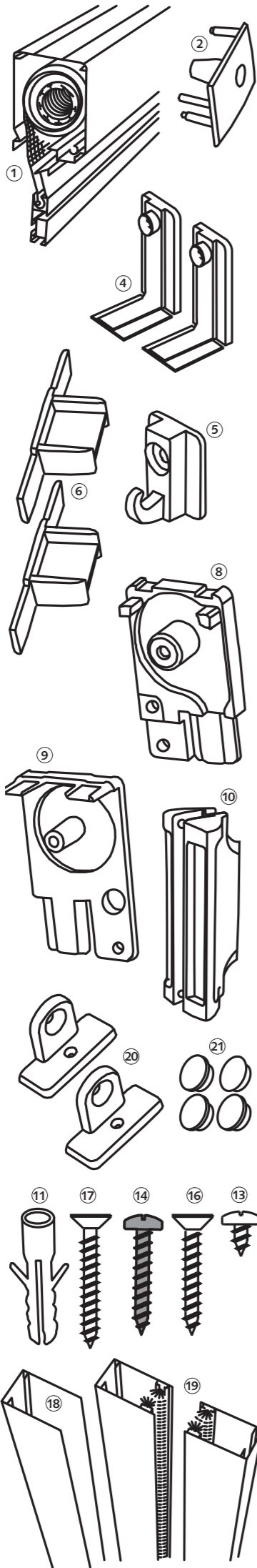

3,5 [cm]

3,2 [cm]

H [cm]

90°

B-4,7 = [cm]

H [cm] =

90°

90°

Ø 6 mm

Ø 4 mm

[mm]

open